

Citroën C4 Picasso (2006-2013)
Citroën C4 Grand Picasso (2006-2013)
Pugeot 5008 (2009-2017)

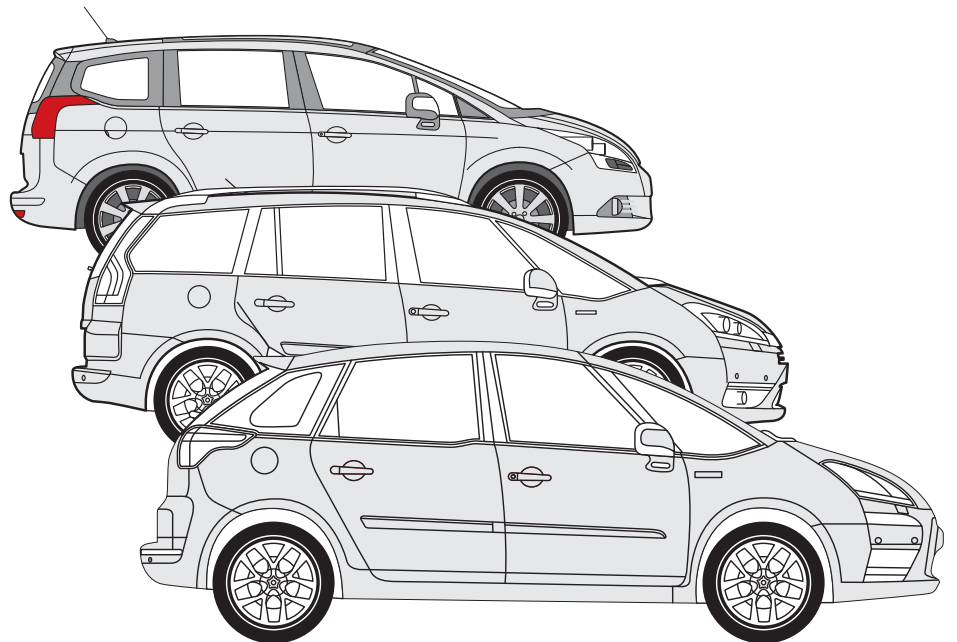

94/20/EC

Citroën C4 Picasso (2006-2013)
 Citroën C4 Grand Picasso (2006-2013)
 Peugeot 5008 (2009-2017)

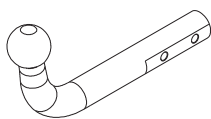

e13	APPROVALNUMBER	D-VALUE
	00-2435	D 9,83 kN
TYPE	CLASS	MAX.VERT.LOAD
CTR027	A50-X	S 80 kg

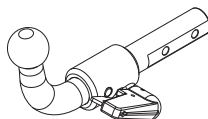

e13	APPROVALNUMBER	D-VALUE
	00-2436	D 9,83 kN
TYPE	CLASS	MAX.VERT.LOAD
CTR028-E	A50-X	S 80 kg

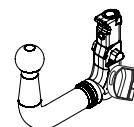

e13	APPROVALNUMBER	D-VALUE
	00-2436	D 9,83 kN
TYPE	CLASS	MAX.VERT.LOAD
CTR028-V	A50-X	S 80 kg

D = 9,83 kN



T = 1765 Kg



S = 80 kg

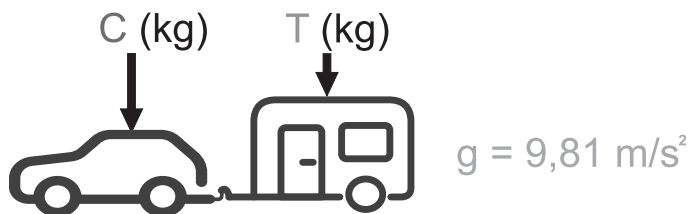
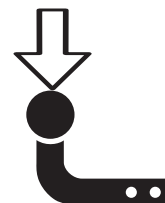

$$D \geq \frac{T \cdot C}{T + C} \cdot \frac{g}{1000} \text{ (kN)}$$

$$T \leq \frac{C \cdot D \cdot 1000}{(C \cdot g) - (1000 \cdot D)} \text{ (kg)}$$

	M8	M10	M12	M14	M16
	N/m	20	40	60	105

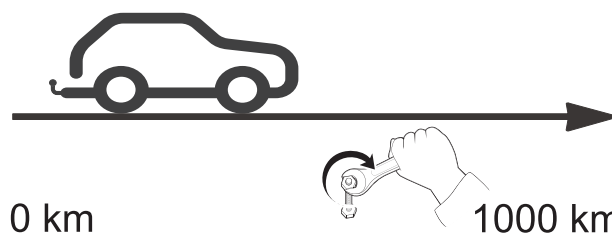

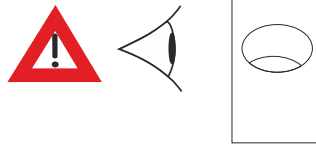

CITROEN C4 PICASSO 7 plazas
PEUGEOT 5008 2009

CITROEN C4 PICASSO 5 plazas

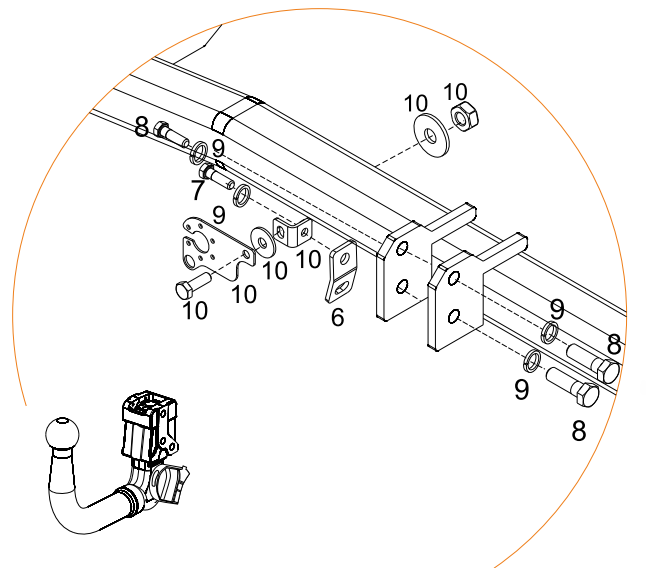
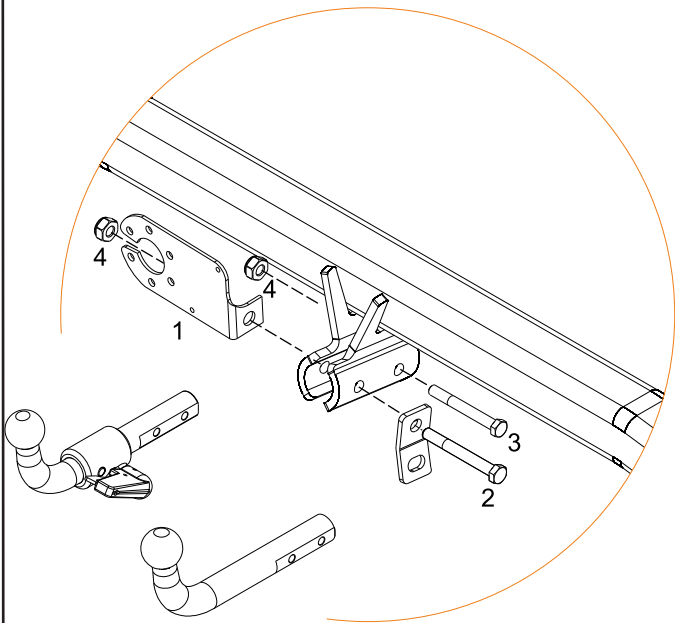
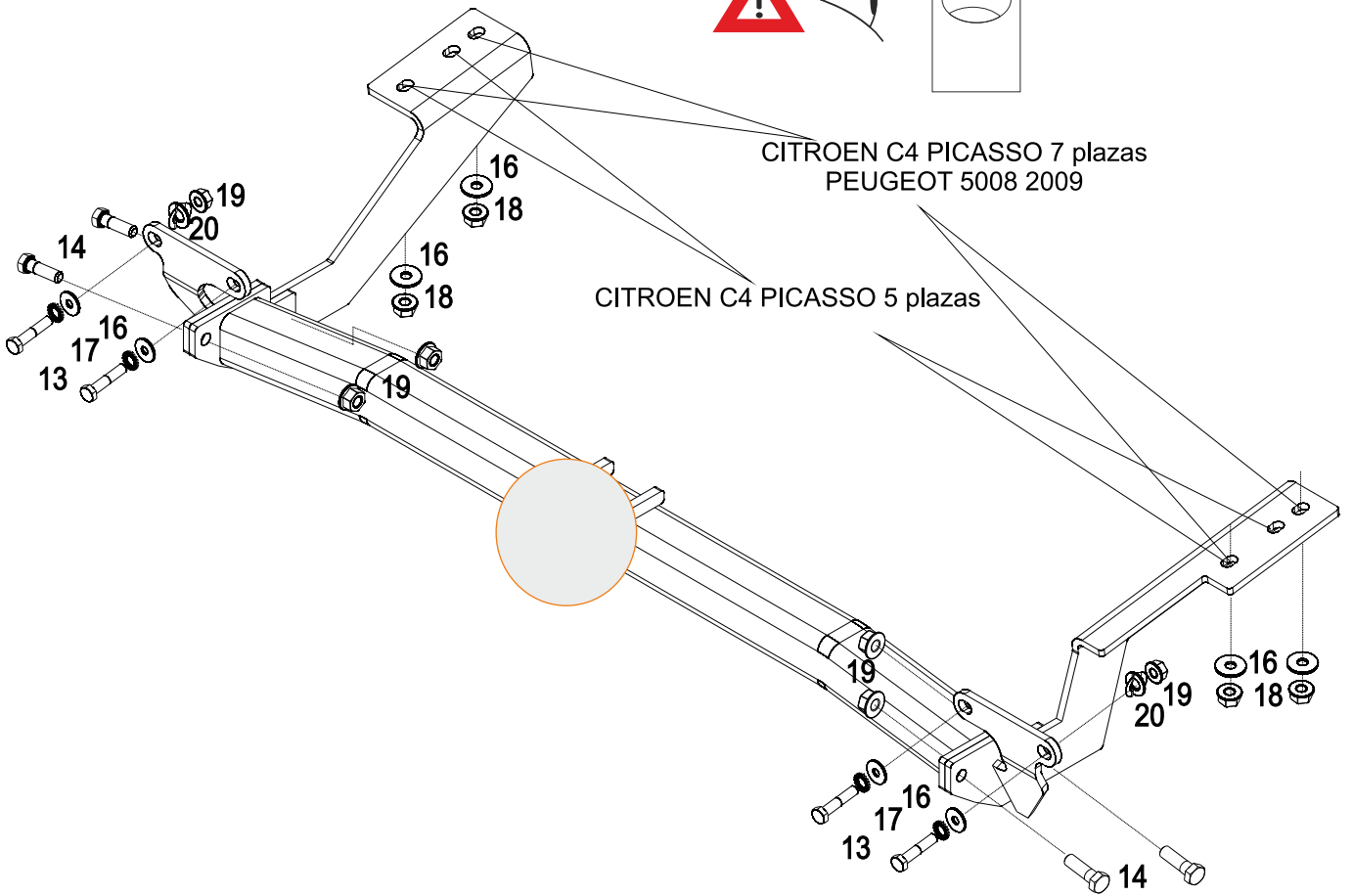

				
1			1	
2		M10x70 DIN 931(8.8)	1	
3		M10x65 DIN 931(8.8)	1	
4		M10 DIN 980	2	
5			1	1
6			1	1
7		M12x35 DIN 933(8.8)		1
8		M12x25 DIN 933(8.8)		4
9		Ø12 DIN 128		4
10				1
11			1	1
12		C1220AA21_A23	1+1	1+1
13		M10x50 DIN 933(8.8)	4	4
14		M12x40 DIN 933(8.8)	4	4
15		M4,8x19 ARA-16 DIN 7504	2	2
16		Ø10 DIN 9021	8	8
17		Ø10 DIN 6798	4	4
18		M10 DIN 6923	4	4
19		M12 DIN 6923	6	6
20			2	2

1

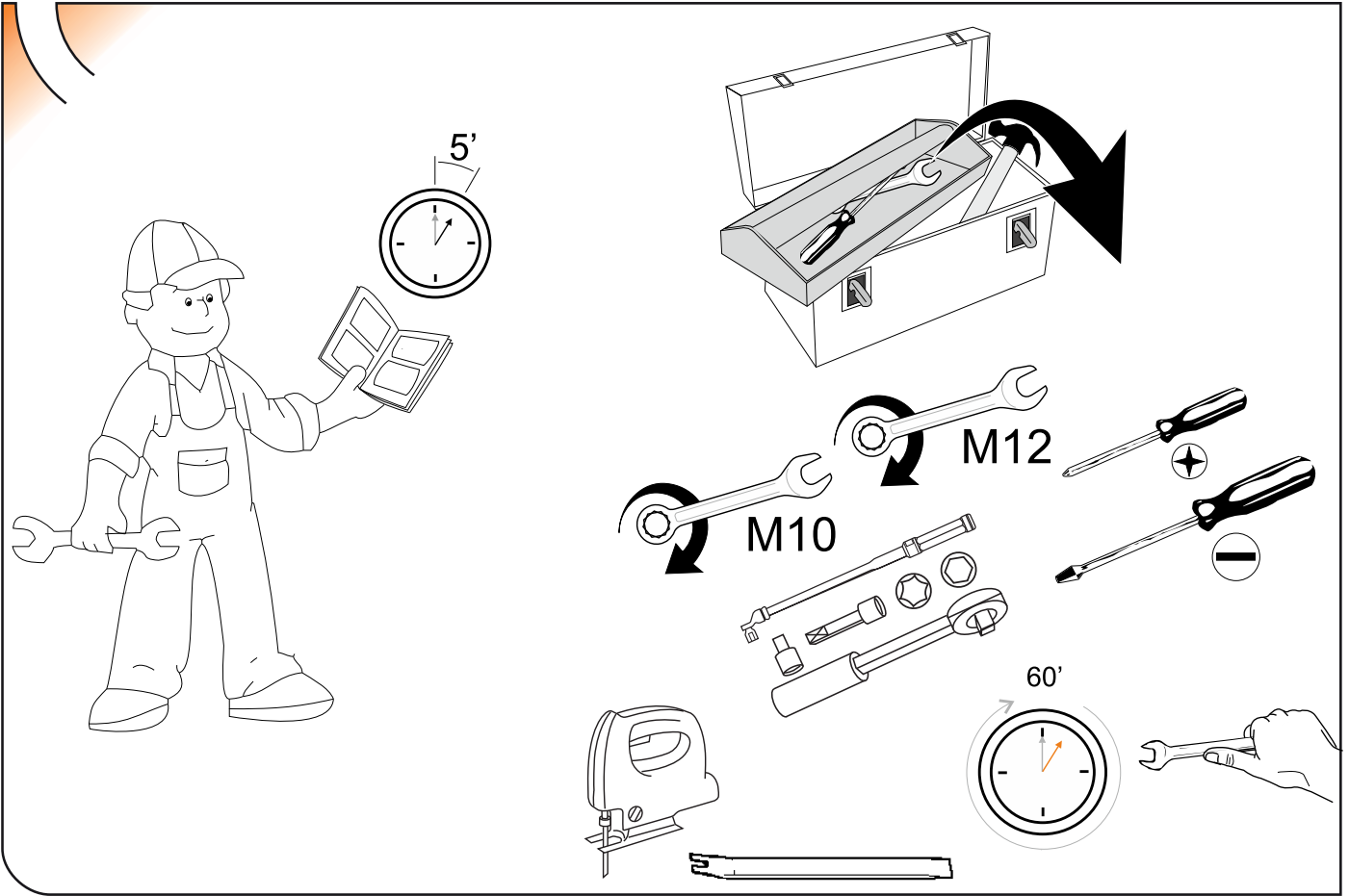

2

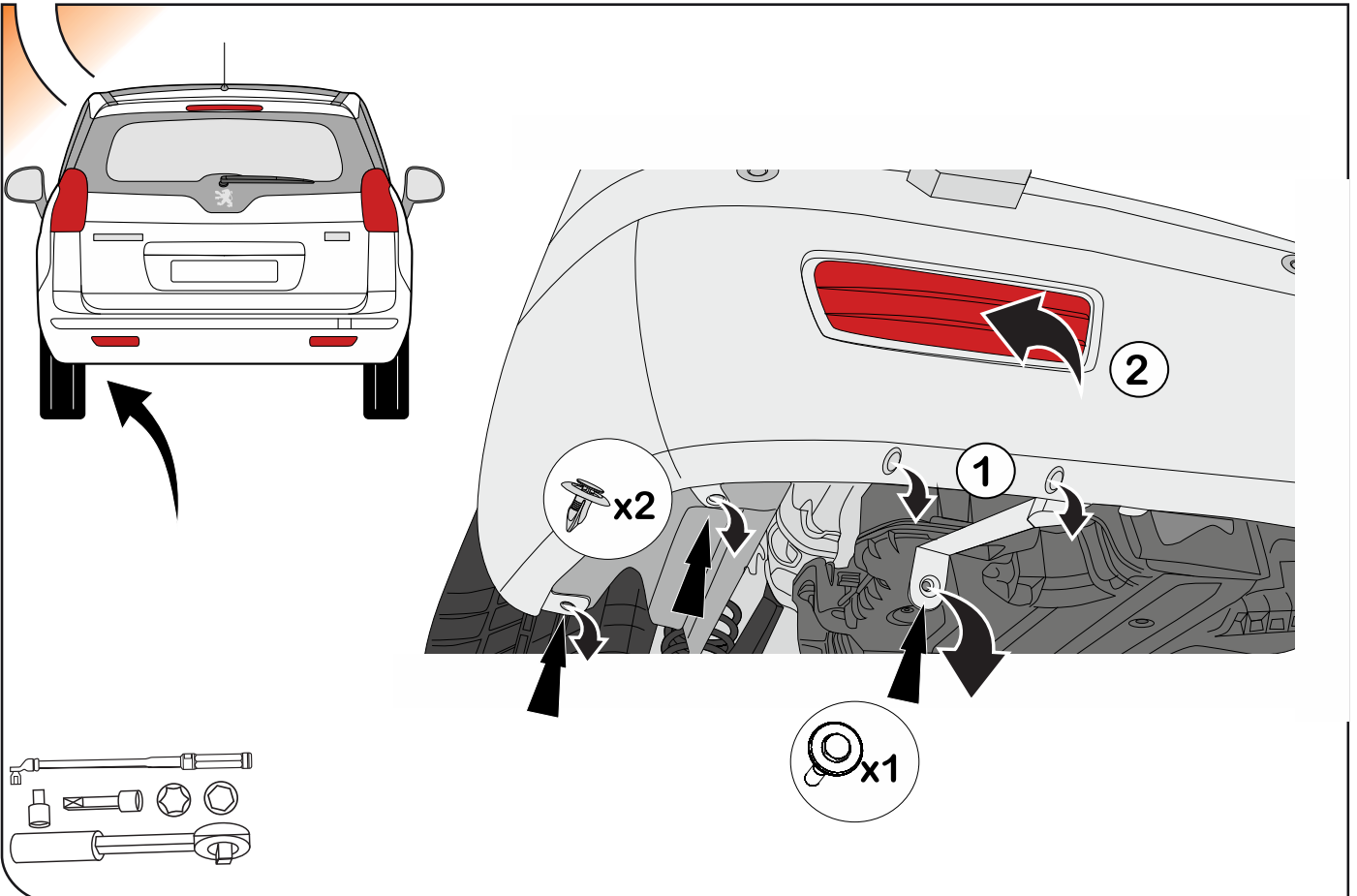

3

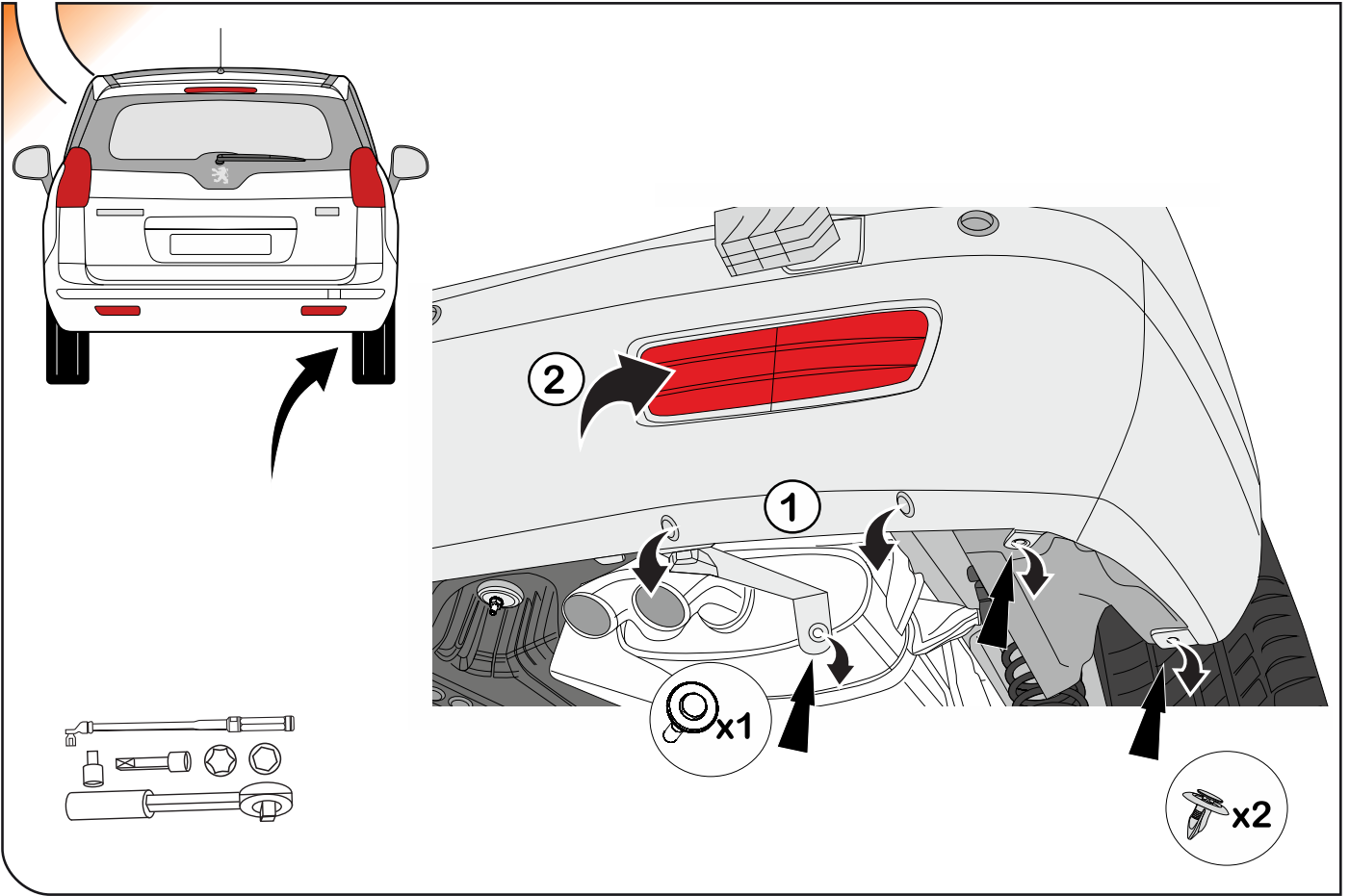

4

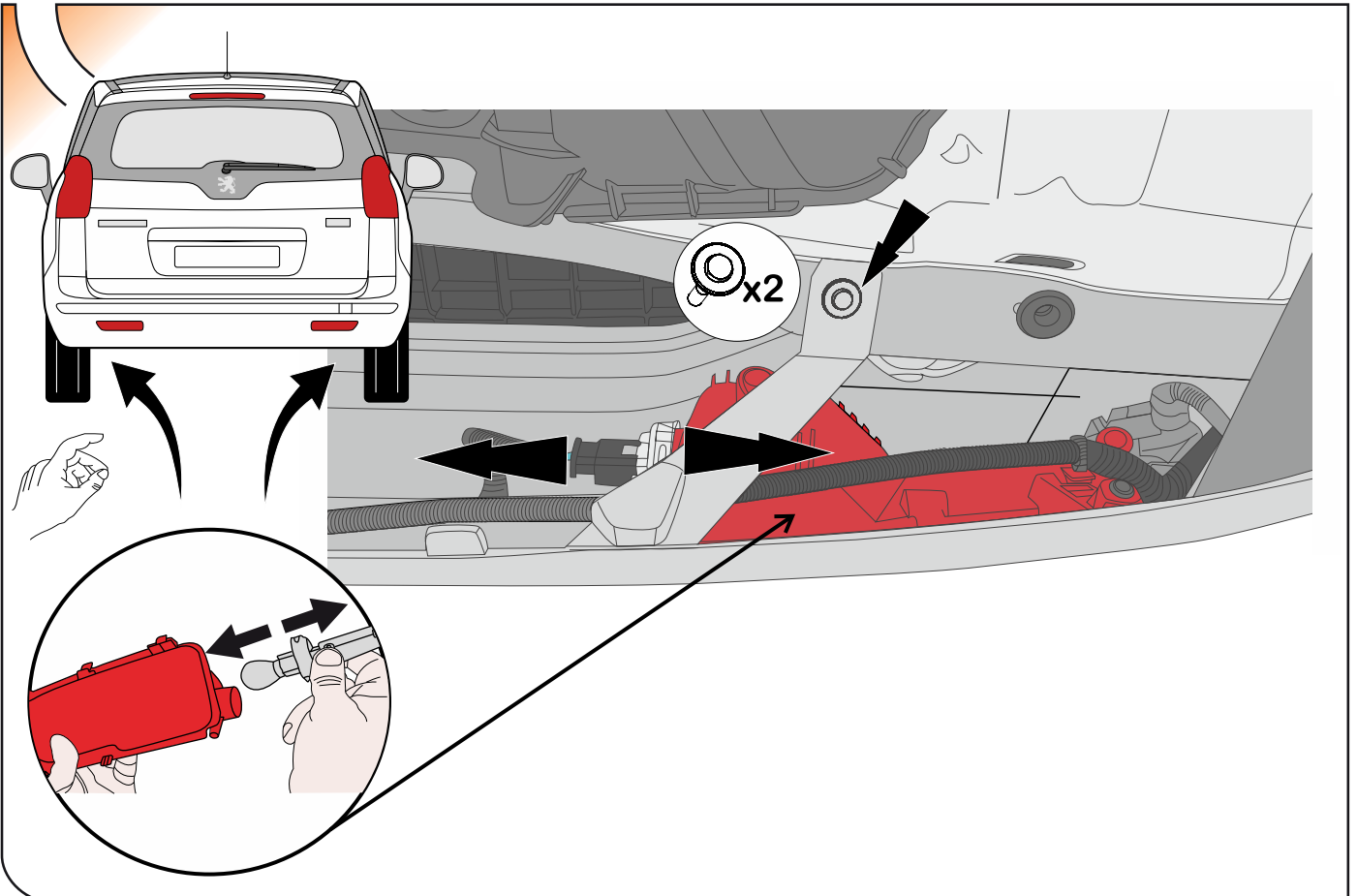



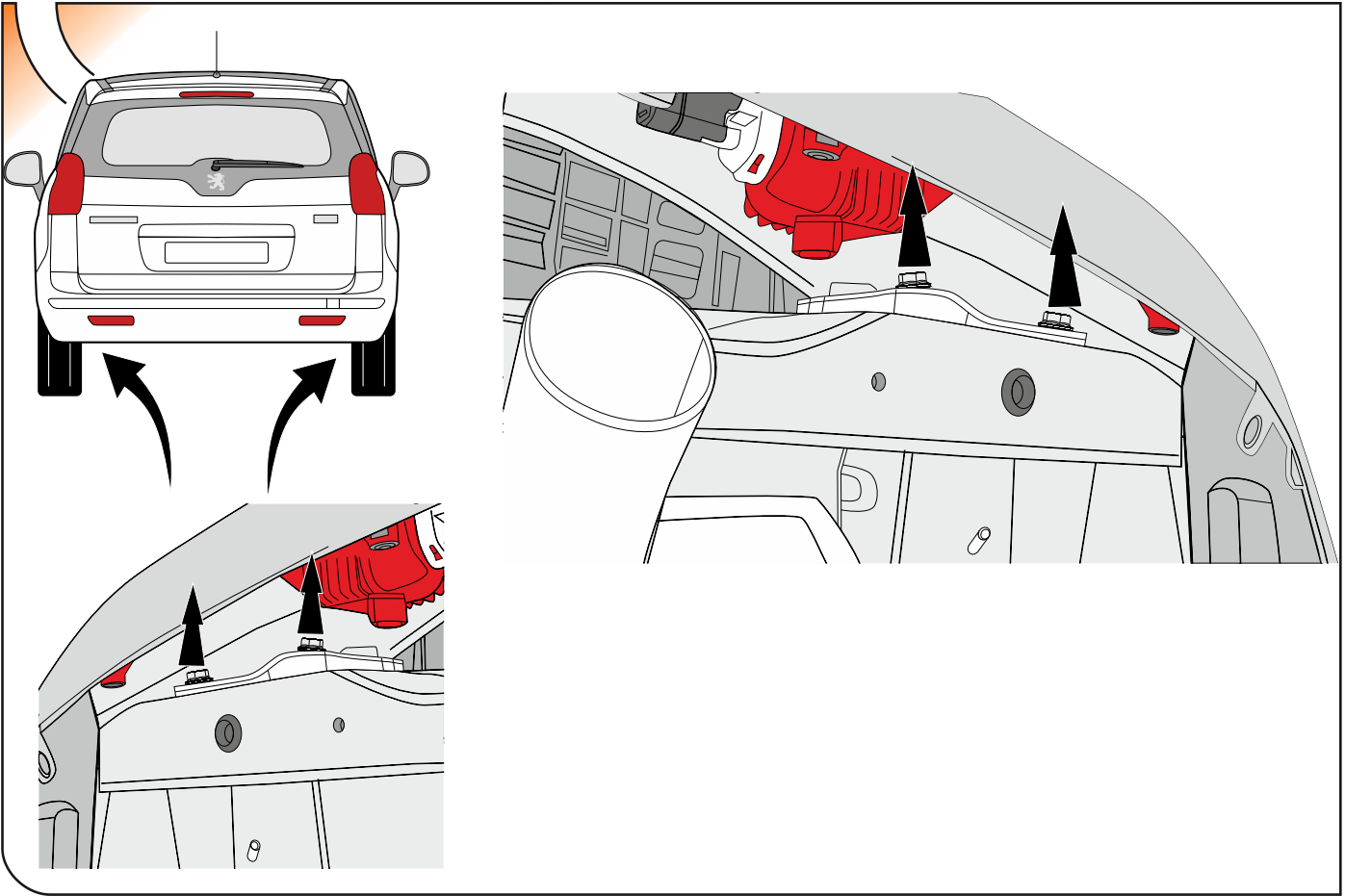

5

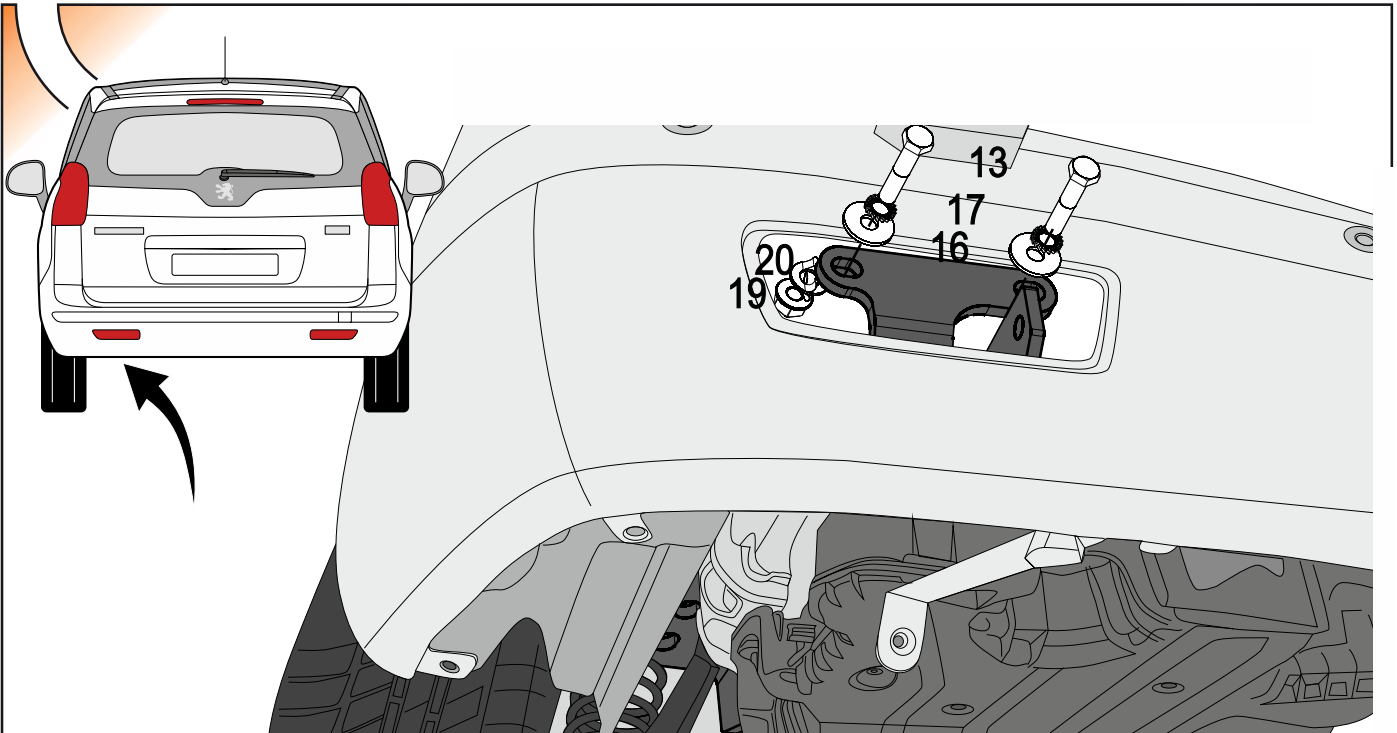



6



- | | | | | | | | | |
|-----|---|-----------|-----|---|--------|-----|---|----|
| 13. |  | x2 M10x50 | 16. |  | x2 Ø10 | 20. |  | x2 |
| 17. |  | x2 Ø10 | 19. |  | x2 M12 | | | |

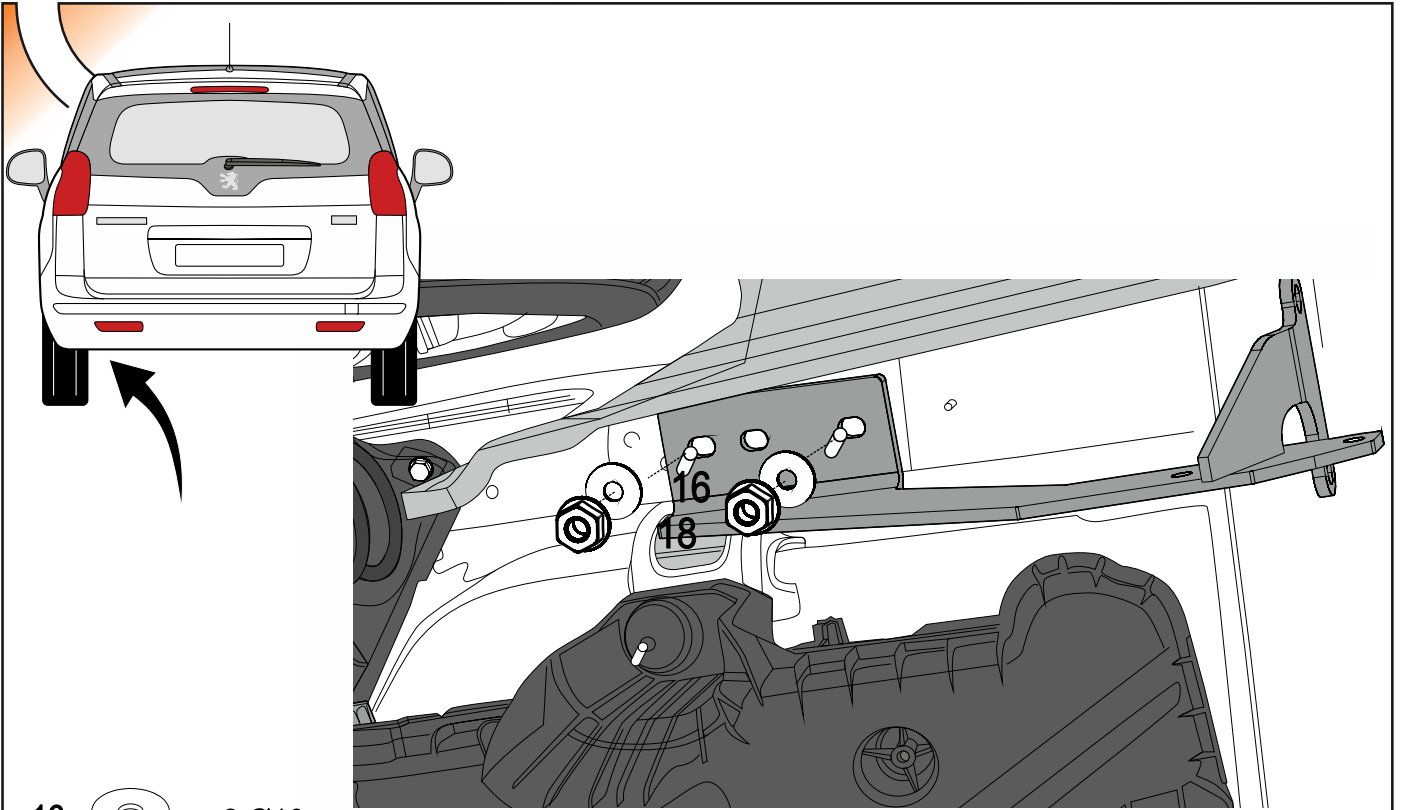



7

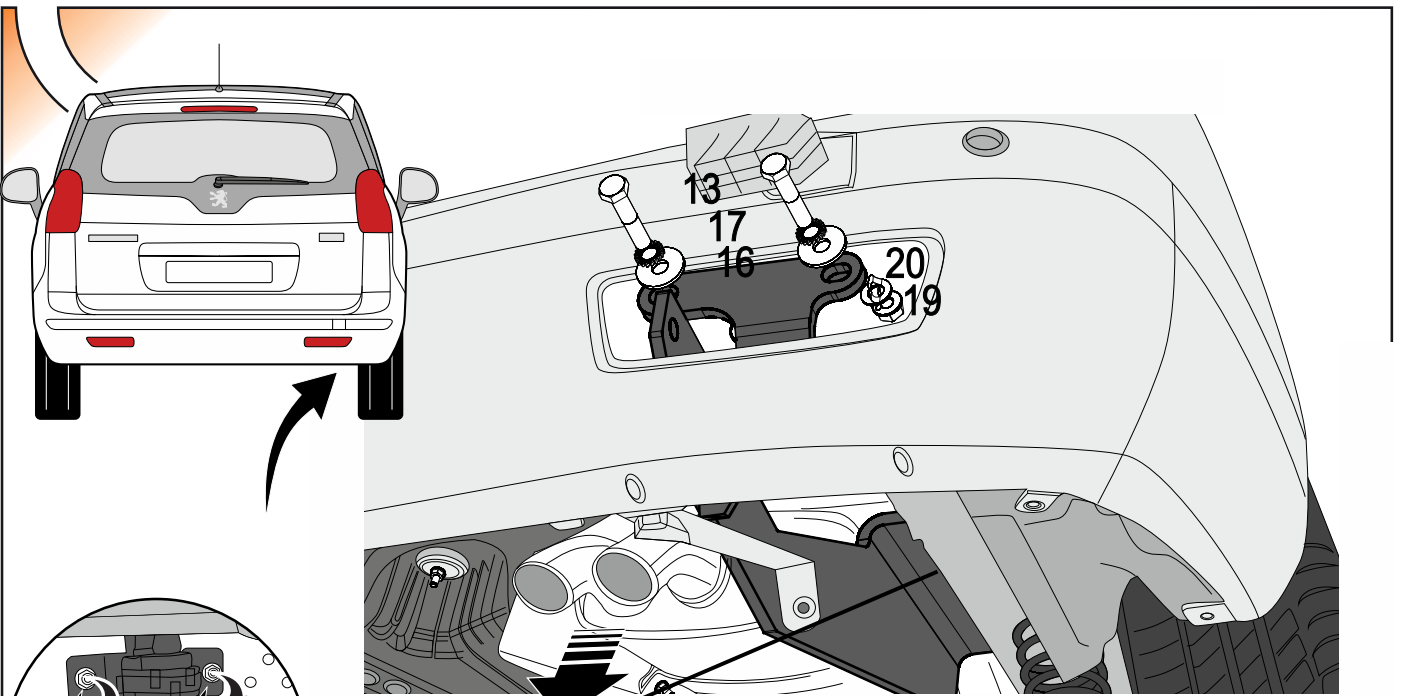

- 16.  x2 Ø10
- 18.  x2 M10

8



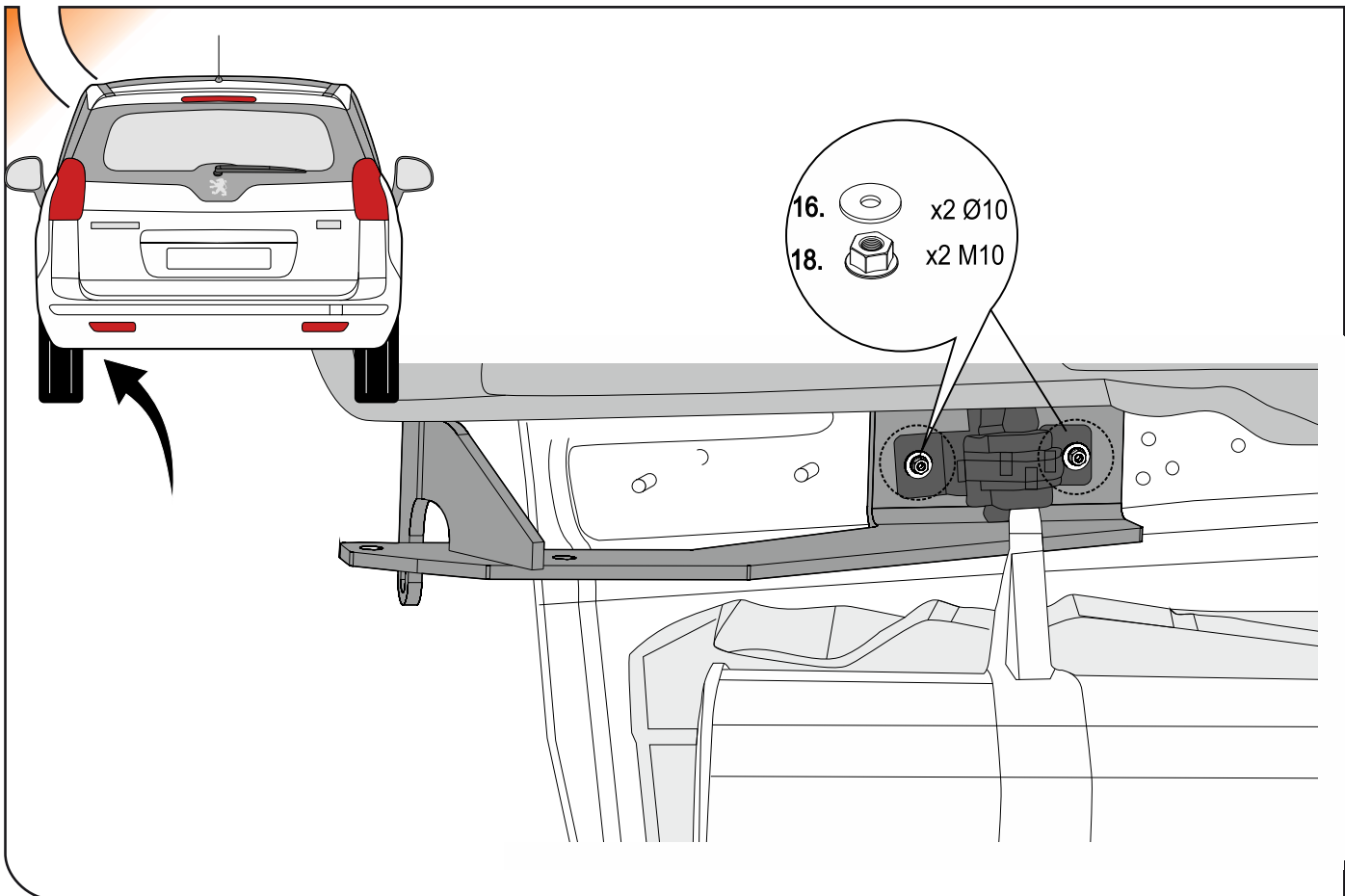

- 13.  x2 M10x50
- 16.  x2 Ø10
- 20.  x2
- 17.  x2 Ø10
- 19.  x2 M12

9



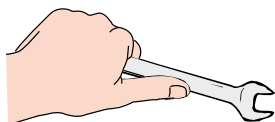
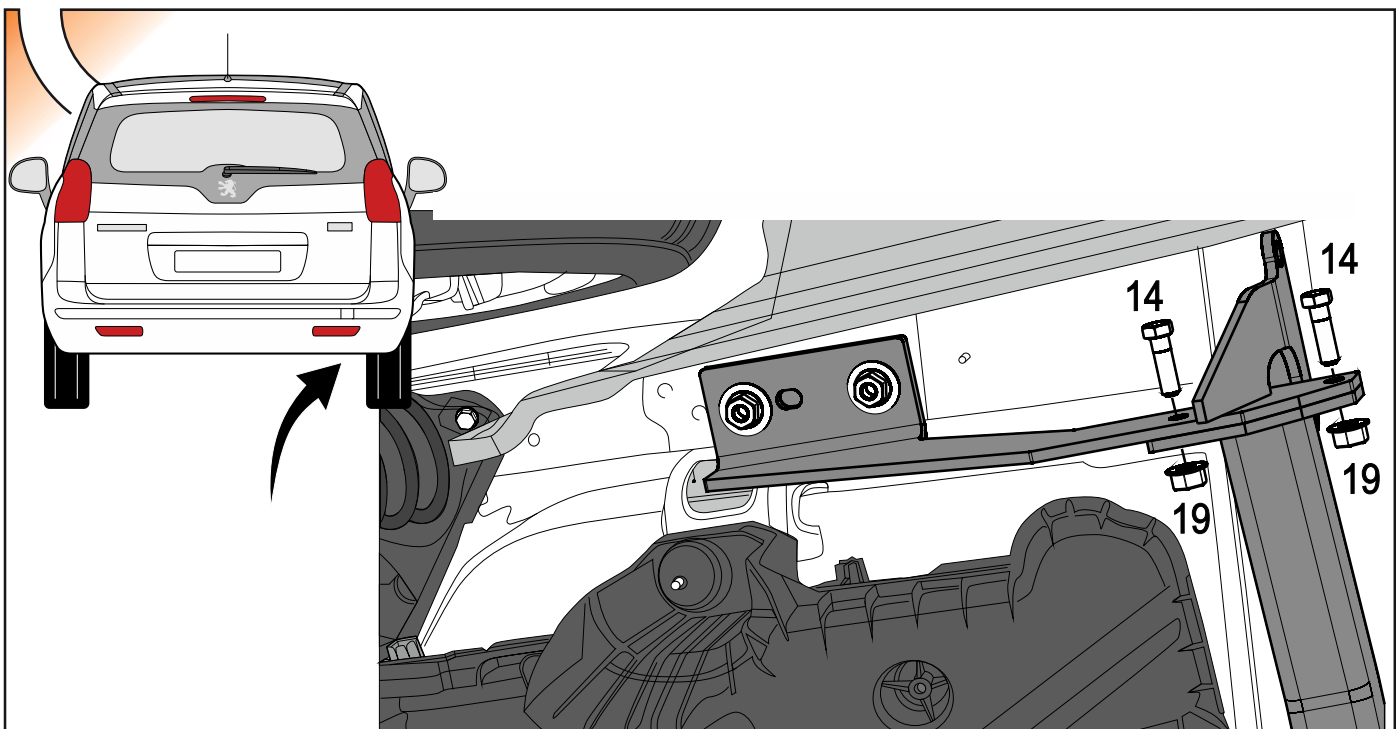

10

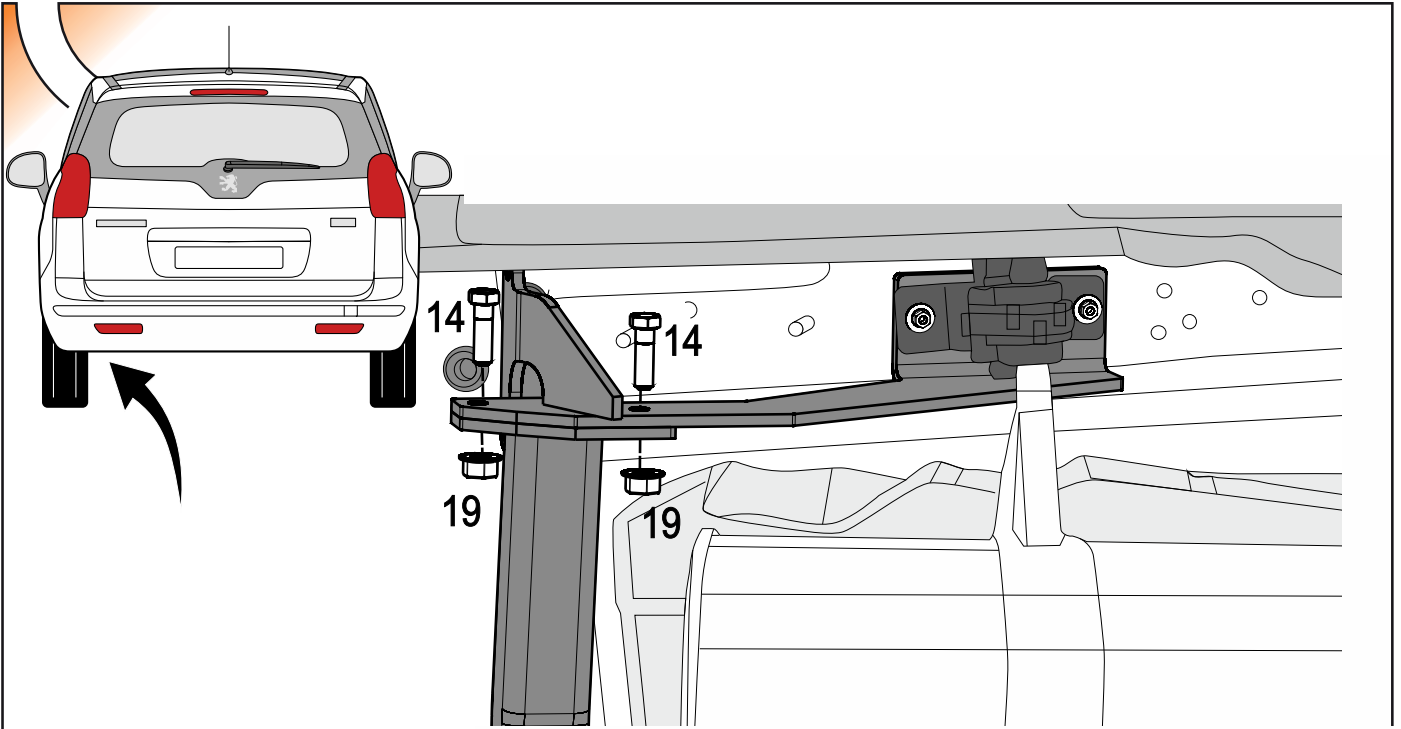

- 14.  M12x40 DIN 933
- 19.  x2 M12

11



- 14.  M12x40 DIN 933
- 19.  x2 M12

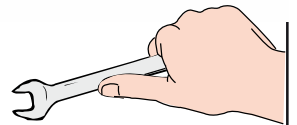

12

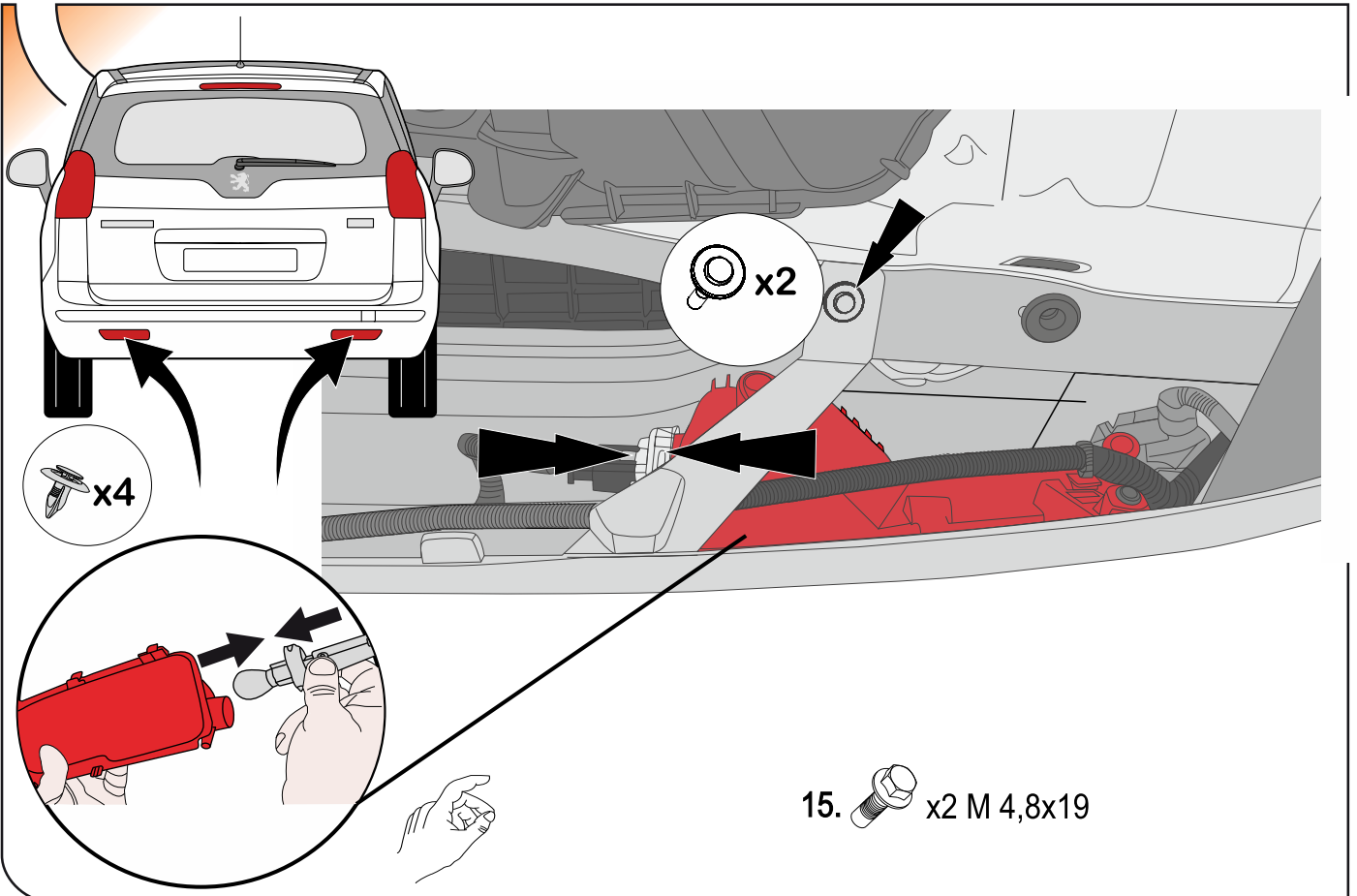

- 15.  x2 M 4,8x19

13

Peugeot 5008

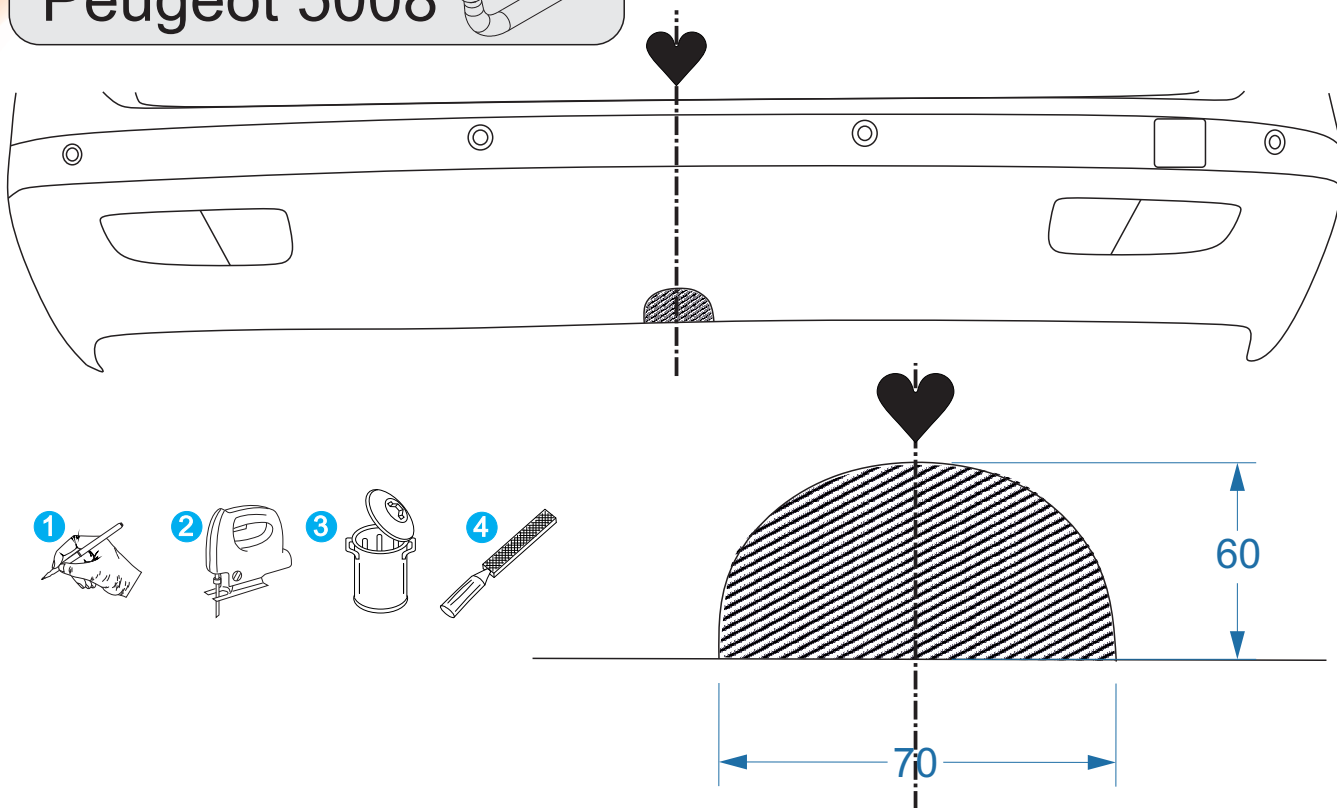
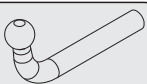

70

60

F IN

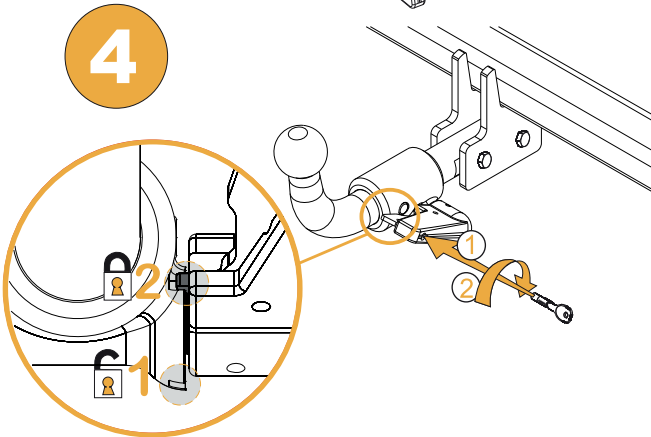
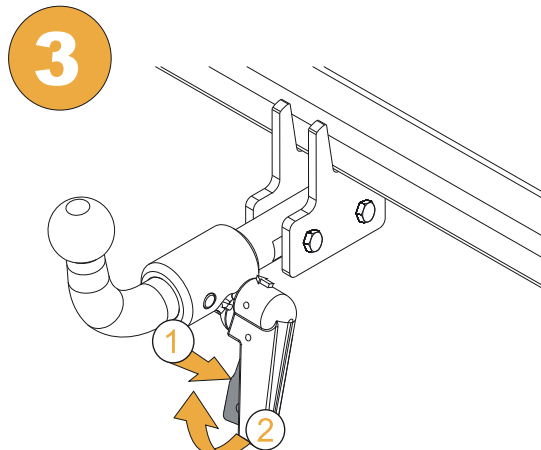
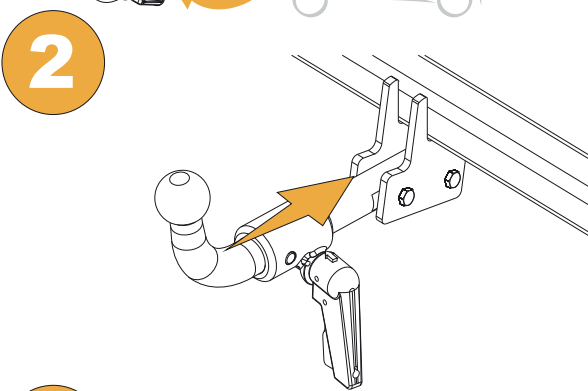
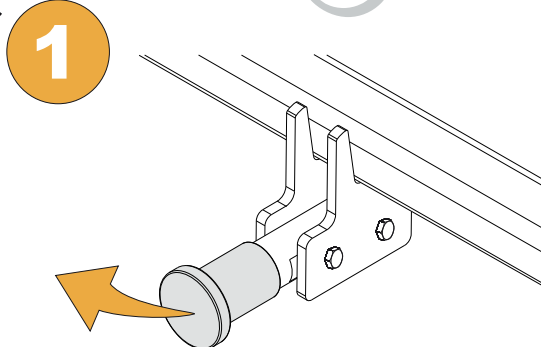

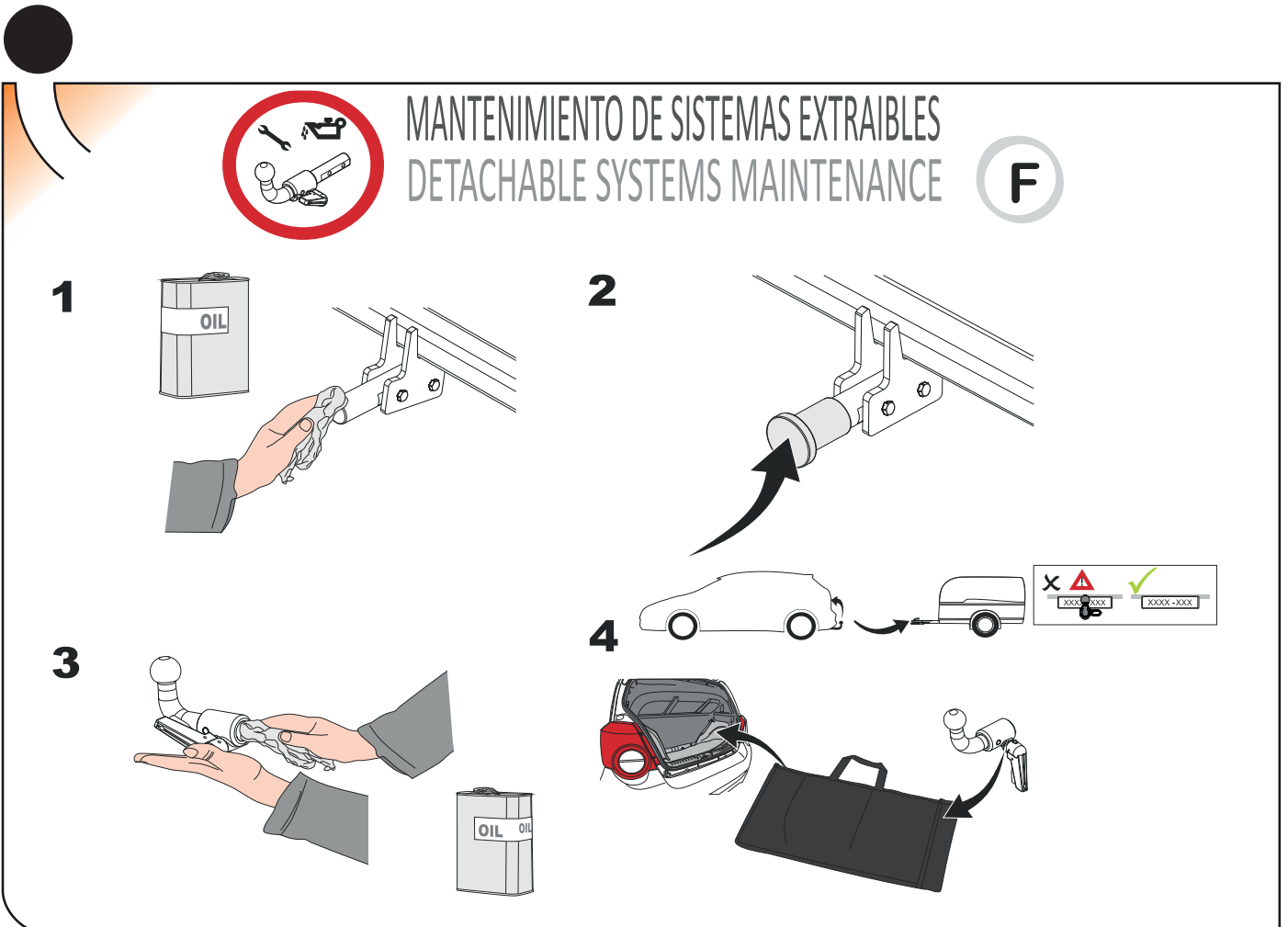
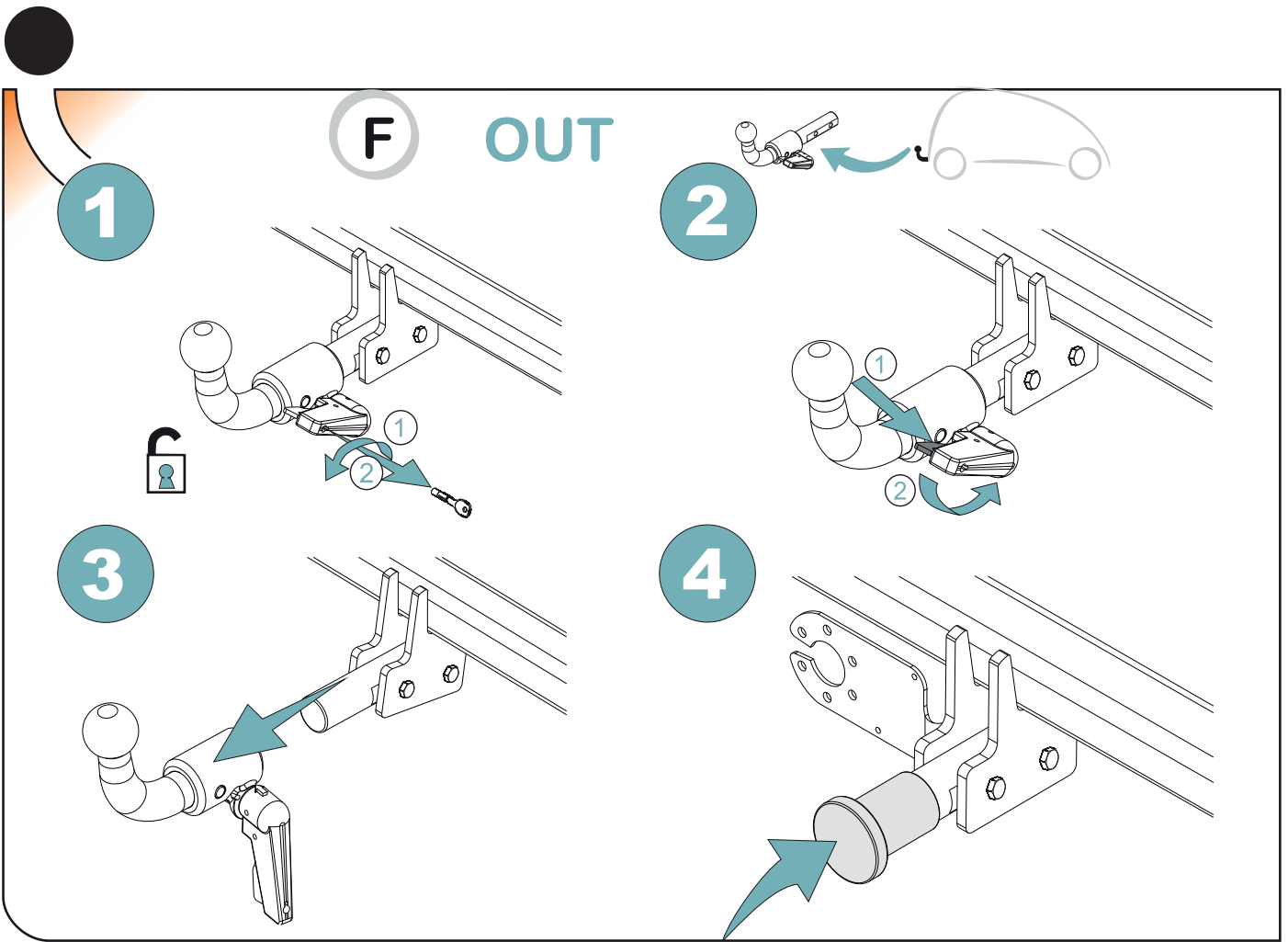

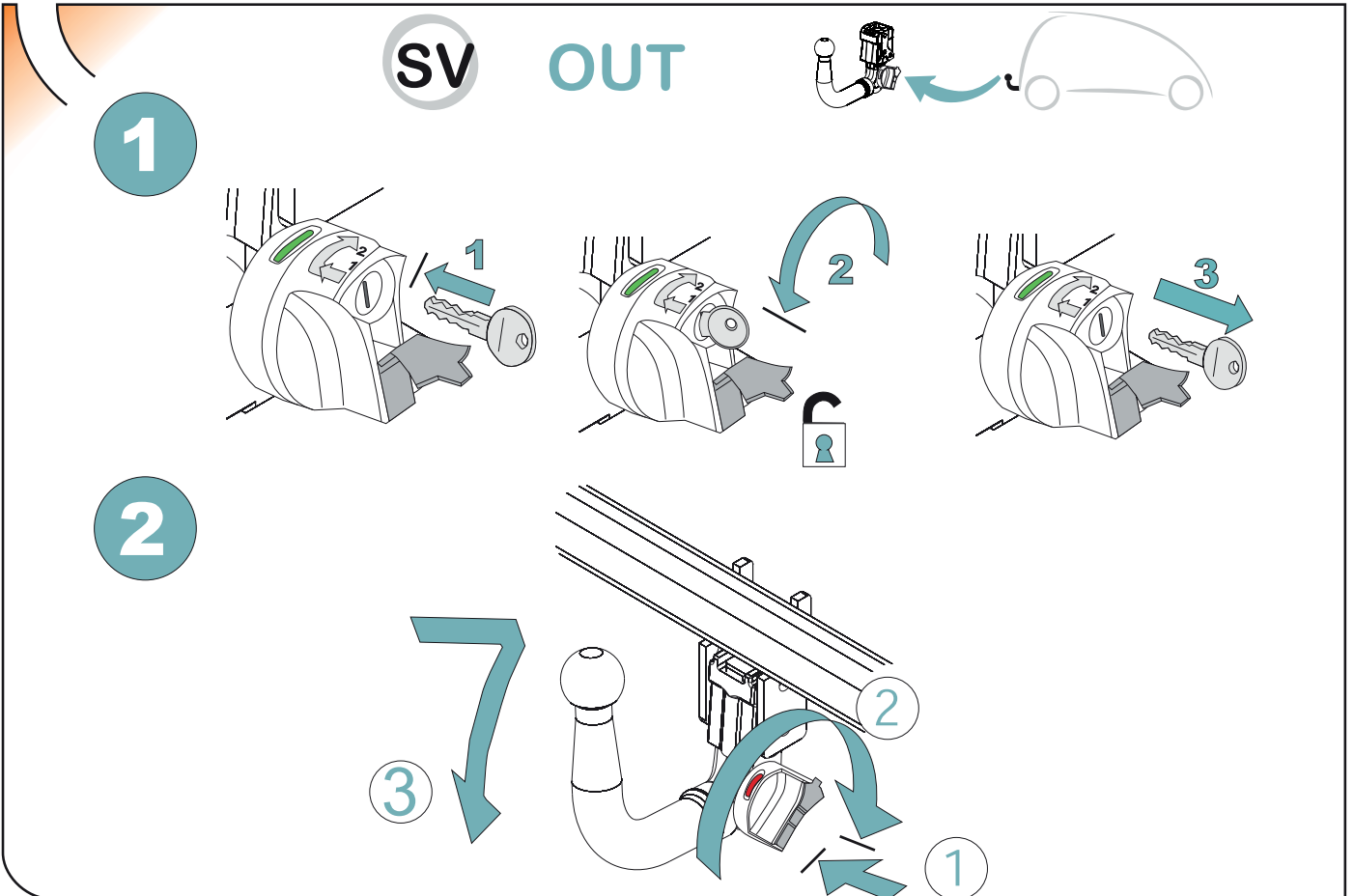
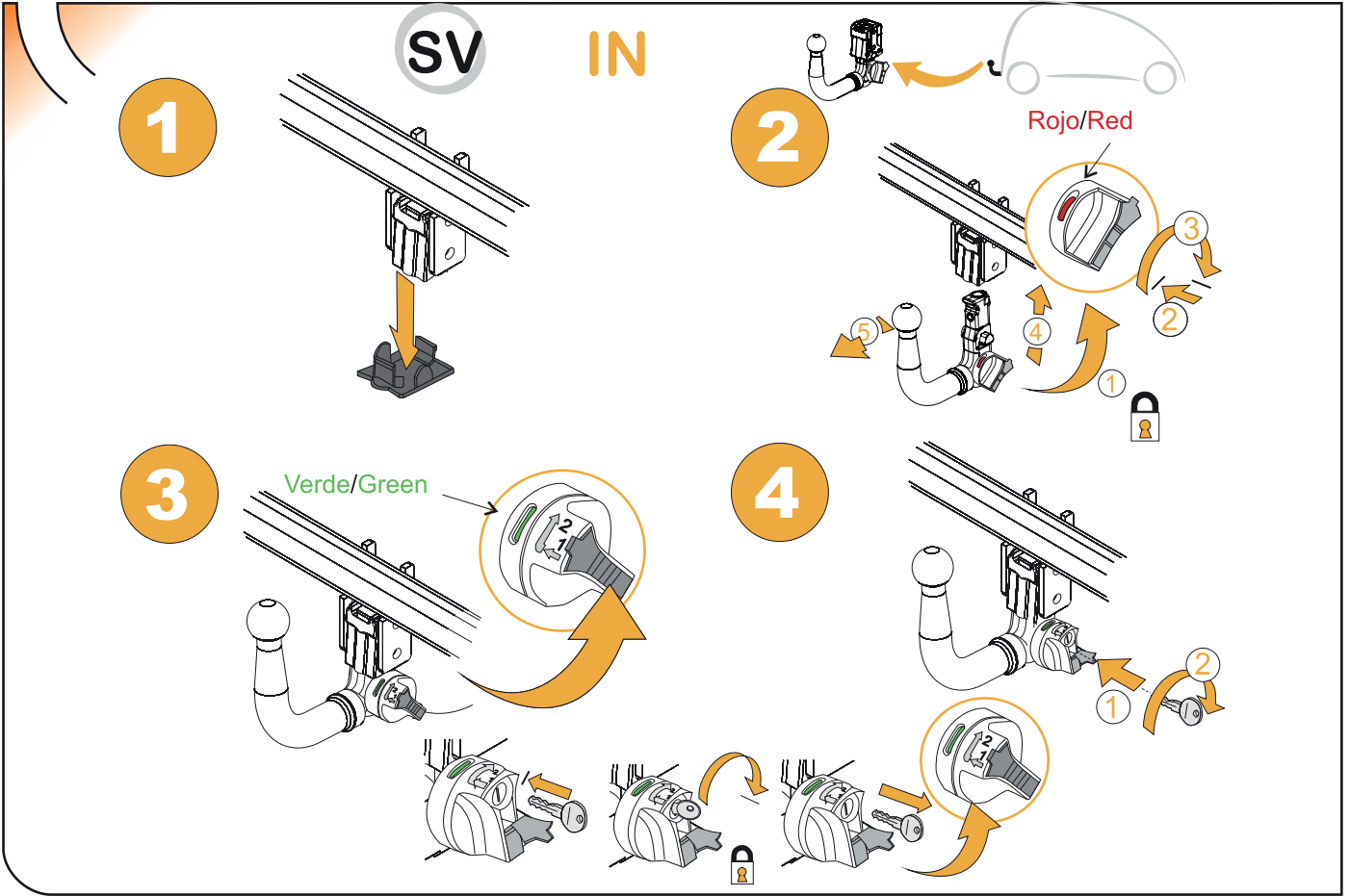

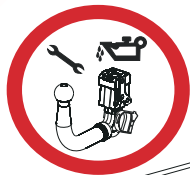

MANTENIMIENTO DE SISTEMAS EXTRAIBLES
DETACHABLE SYSTEMS MAINTENANCE

SV

1

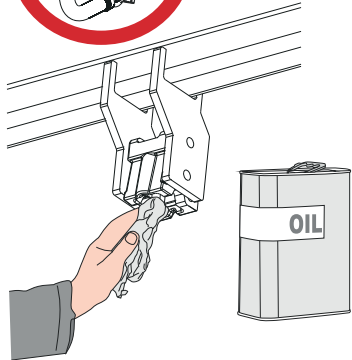

2

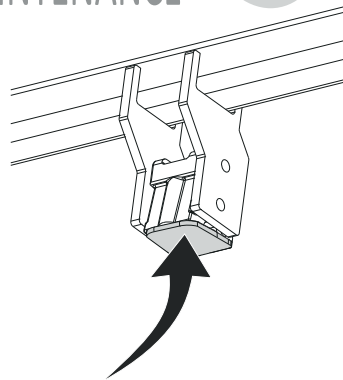

3

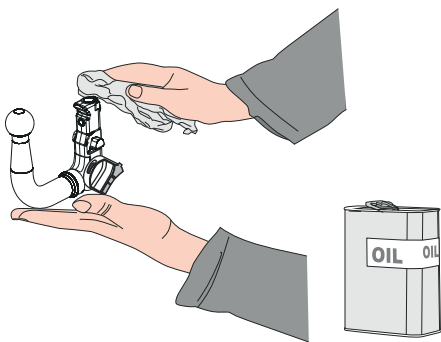

4

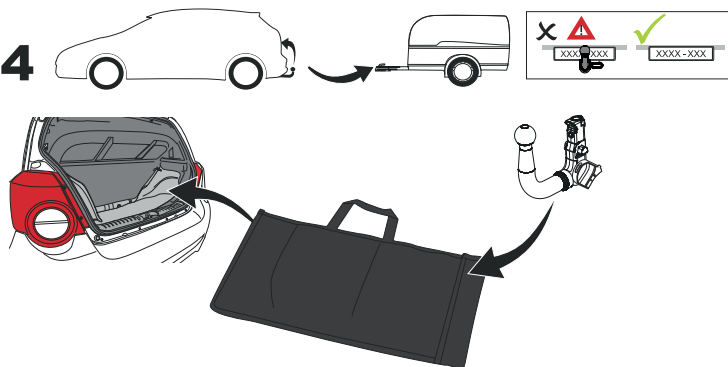



ANEXO III

CERTIFICADO DE TALLER

D. _____, expresamente autorizado por la _____
domiciliada en _____, teléfono _____, dedicada
a la actividad de _____ n° de Registro Industrial _____ y n° de registro
especial _____.

CERTIFICA

Que la mencionada empresa ha realizado la/s Reforma/s y asume la responsabilidad de la ejecución,
sobre el vehículo marca....., tipo.....
variante..... denominación comercial
matrícula y n° de bastidor, de acuerdo con:

- La normativa vigente en materia de reformas de vehículos.
- Las normas del fabricante del vehículo aplicables a la/s reforma/s llevadas a cabo en dicho vehículo.
- El proyecto descriptivo de la/s reforma/s, adjunto al expediente.

OBSERVACIONES: (2)

Tipificada/s con el código de reforma/s.....
Reforma consiste en:

COLOCACION DE ENGANCHE _____

n° de identificación / marca de homologación

Type :

Fecha:

Firma y sello:

Fdo:

(1) En el caso de que la reforma sea efectuada por el fabricante se indicará N/A.

(2) Se debe especificar en este apartado OBSERVACIONES, la identificación de los equipos o sistemas modificados, garantizando que se cumple lo previsto en el artículo 6 del reglamento general de vehículos y, en su caso, en el artículo 5 del R. D. 1457/1986 de 10 de enero, por el que se regula la actividad industrial en talleres de vehículos automóviles, de equipos y sus componentes, modificado por 455/2010 de 16 de abril, por el que se modifica el R. D. 1457/1986 de 10 de enero por el que se regulan la actividad industrial y la prestación.

ES

1



2

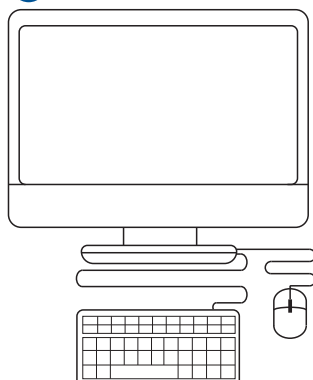

3



IT

1

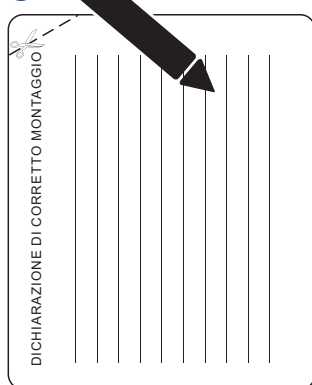

2

